

MALLEABLE IRON CABLE CONNECTORS

FOR ARMORED CABLE, METAL CLAD AND FLEXIBLE METALLIC CONDUIT

APPLICATION

Used to connect steel armored cable to box or enclosure.

FEATURES

- UL Listed flexible metal conduit fittings are suitable for use in Hazardous Locations under NEC 501-4(b) Class I Div. II, and suitable as a grounding means under NEC 350-5
- Male Hub Threads-NPSM
- Provided with steel locknuts

STANDARD MATERIALS

Malleable Iron / Steel Locknuts

STANDARD FINISH

Zinc Plated



*Please see Cable Chart for Cable Connectors on page 158.

Set-Screw



TYPE C22M

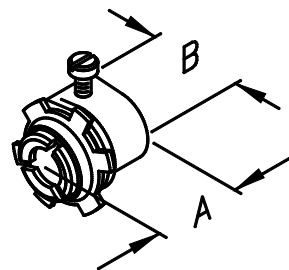

CATALOG NUMBER	TRADE SIZE	KO SIZE	DIM A	DIM B	UNIT PACK	MASTER PACK	LBS. / 100 PCS.	UPC #
C22M	3/8"	1/2"	1.000	0.438	100	1000	7	31240

APPLICATION

Strap type fitting used to connect flexible metal conduit or armored cable to box or enclosure.

FEATURES

- UL Listed flexible metal conduit fittings are suitable for use in Hazardous Locations under NEC 501-4(b) Class I Div. II, and suitable as a grounding means under NEC 350-5
- Male Hub Threads-NPSM
- Provided with steel locknuts
- Stamped Steel Covers

STANDARD MATERIALS

Malleable Iron / Steel Locknuts

STANDARD FINISH

Zinc Plated



Duplex

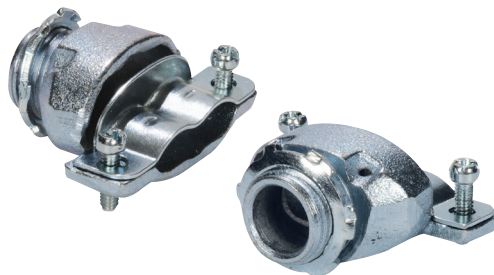

TYPE C270M

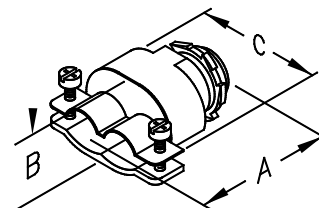

CATALOG NUMBER	TRADE SIZE	KO SIZE	DIM A	DIM B	DIM C	UNIT PACK	MASTER PACK	LBS. / 100 PCS.	UPC #
C270M	3/8"	1/2"	1.688	0.438	1.625	20	200	14	52802