

ALUMINUM SET-SCREW CONDUIT BODIES WITH COVER AND GASKET

FOR EMT CONDUIT

APPLICATION

To provide access to conductors for pulling, splicing, and maintenance. Used for thinwall conduit.

FEATURES

- Die cast from high-strength, corrosion and weather resistant, copper-free aluminum alloy.
- Flat back design for easy mounting close to walls.
- Assembled with neoprene gasket and stamped cover.

STANDARD MATERIALS

1/2" - 2"
Die Cast/Copper-Free
Aluminum

2 1/2" - 4"
Sand-Cast Copper-Free
Aluminum

STANDARD FINISH

Aluminum Enameled



TYPE C1ATCG

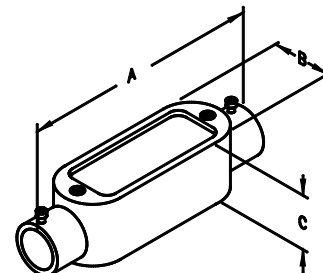

CATALOG NUMBER	TRADE SIZE	DIM A	DIM B	DIM C	MAX WIRE SIZE	VOL. CU.IN.	UNIT PACK	MASTER PACK	LBS. / 100 PCS.	UPC #
C TYPE										
C1ATCG	1/2"	4.69	1.38	1.31	N/A	4.35	10	50	21	10400
C2ATCG	3/4"	5.50	1.56	1.63	3 #6 AWG	7.30	10	50	33	10401
C3ATCG	1"	6.48	1.88	1.88	3 #4 AWG	12.20	5	25	46	10402
C4ATCG	1-1/4"	8.31	2.50	2.50	3 #2 AWG	33.50	-	10	82	10403
C5ATCG	1-1/2"	8.38	2.50	2.50	3 #1/0 AWG	33.50	-	10	85	10404
C6ATCG	2"	10.31	3.38	3.38	3 #4/0 AWG	69.50	-	5	188	10405
C7ATCG	2-1/2"	13.12	4.50	4.00	3 #250 MCM	69.50	-	1	325	10406
C8ATCG	3"	13.19	4.56	4.56	3 #250 MCM	188.00	-	1	399	10407
C9ATCG	3-1/2"	16.12	5.69	5.63	3 #300 MCM	307.00	-	1	975	10408
C10ATCG	4"	16.12	5.69	5.63	3 #300 MCM	309.00	-	1	875	10409



TYPE LB1ATCG

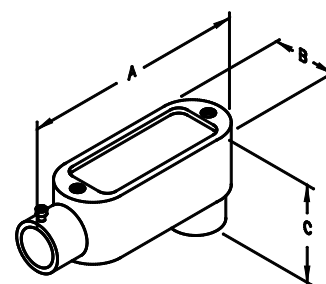

CATALOG NUMBER	TRADE SIZE	DIM A	DIM B	DIM C	MAX WIRE SIZE	VOL. CU.IN.	UNIT PACK	MASTER PACK	LBS. / 100 PCS.	UPC #
LB TYPE										
LB1ATCG	1/2"	4.31	1.31	2.19	N/A	4.35	10	50	24	10410
LB2ATCG	3/4"	5.06	1.56	2.44	3 #6 AWG	7.25	10	50	37	10411
LB3ATCG	1"	5.87	1.75	2.75	3 #4 AWG	12.20	5	25	46	10412
LB4ATCG	1-1/4"	7.81	2.50	3.44	3 #2 AWG	32.30	-	10	98	10413
LB5ATCG	1-1/2"	7.81	2.50	3.44	3 #2 AWG	33.80	-	10	91	10414
LB6ATCG	2"	10.06	3.12	4.31	3 #4/0 AWG	71.20	-	5	222	10415
LB7ATCG	2-1/2"	12.81	4.50	5.31	3 #4/0 AWG	71.20	-	1	366	10416
LB8ATCG	3"	12.81	4.50	5.94	3 #4/0 AWG	183.50	-	1	430	10417
LB9ATCG	3-1/2"	15.62	5.56	7.06	3 #400 MCM	304.90	-	1	937	10418
LB10ATCG	4"	15.62	5.56	7.06	3 #400 MCM	308.00	-	1	851	10419