

MALLEABLE IRON AND ZINC CONDUIT BUSHINGS

FOR THREADED RIGID CONDUIT AND IMC

APPLICATION

Used with a locknut to terminate threaded rigid and IMC conduit to a box or enclosure.

FEATURES

- Bushing surface rounded to prevent damage to wire insulation during pulling.

STANDARD MATERIALS

Malleable Iron

STANDARD FINISH

Zinc plated



Malleable Iron

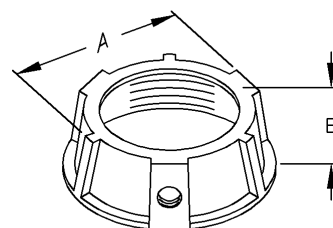

TYPE 806

CATALOG NUMBER	TRADE SIZE	DIM A	DIM B	UNIT PACK	MASTER PACK	LBS. / 100 PCS.	UPC #
806	1/2"	1.06	0.38	100	1000	6	18061
807	3/4"	1.25	0.44	100	1000	9	18071
808	1"	1.50	0.56	50	500	13	18081
809	1-1/4"	1.88	0.75	25	250	16	18091
810	1-1/2"	2.19	0.69	25	250	21	18101
811	2"	2.63	0.81	-	25	25	18111
812	2-1/2"	3.13	0.81	-	25	50	18121
814	3"	3.75	1.00	-	25	66	18141
815	3-1/2"	4.31	1.00	-	25	71	18151
816	4"	4.88	1.00	-	25	102	18161
817	5"	6.13	1.13	-	10	146	18171
818	6"	7.19	1.13	-	10	183	18181

STANDARD MATERIALS

Zinc Die Cast



Zinc Die Cast

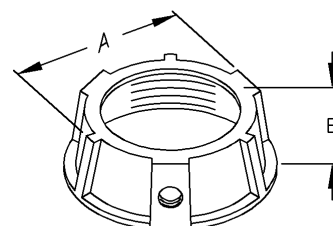

TYPE 806Z

CATALOG NUMBER	TRADE SIZE	DIM A	DIM B	UNIT PACK	MASTER PACK	LBS. / 100 PCS.	UPC #
806Z	1/2"	1.15	0.47	100	1000	3	18062
807Z	3/4"	1.41	0.47	100	1000	4	18072
808Z	1"	1.68	0.54	50	500	7	18082
809Z	1-1/4"	1.94	0.60	25	250	15	18092
810Z	1-1/2"	2.20	0.62	25	250	19	18102
811Z	2"	2.80	0.62	-	25	22	18112
812Z	2-1/2"	3.32	0.93	-	25	42	18122
814Z	3"	3.94	0.93	-	25	51	18142
815Z	3-1/2"	4.45	0.94	-	25	68	18152
816Z	4"	5.00	0.97	-	25	98	18162