

MALLEABLE IRON THREADED CONDUIT BODIES

FOR THREADED RIGID CONDUIT AND IMC

APPLICATION

To provide access to conductors for pulling, splicing, and maintenance. Threaded for rigid conduit and IMC.

FEATURES

- Tapered threaded hubs (NPT)
- Flat back design for easy mounting close to walls
- Suitable for use in concrete

STANDARD MATERIALS

Malleable Iron

STANDARD FINISH

Zinc Plated

OPTIONAL FINISH

For additional corrosion protection, specify Hot Dipped Galvanized. Add suffix 'G' to Malleable Iron catalog number. Example T1G. For more information, see page 13.

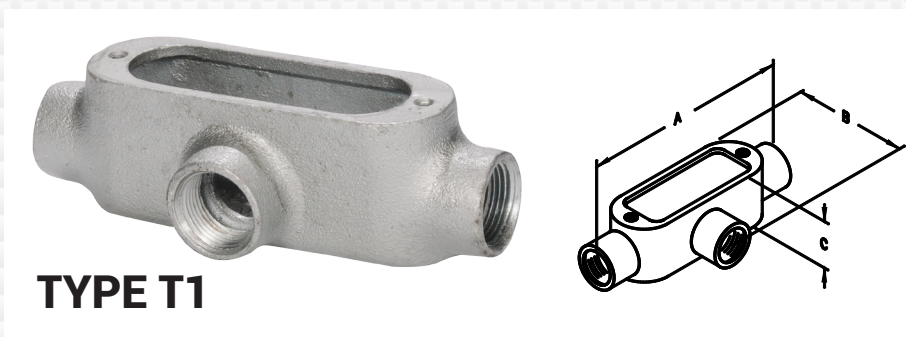

TYPE T1

CATALOG NUMBER	TRADE SIZE	DIM A	DIM B	DIM C	MAX WIRE SIZE	VOL. CU.IN.	UNIT PACK	MASTER PACK	LBS. / 100 PCS.	UPC #
T TYPE										
T1	1/2"	5.375	2.063	1.313	N/A	6.00	10	50	111	44011
T2	3/4"	6.000	2.250	1.500	3 #6 AWG	9.50	10	50	137	44021
T3	1"	7.063	2.625	1.813	3 #4 AWG	15.00	5	25	195	44031
T4	1-1/4"	9.000	2.750	2.625	3 #2 AWG	33.00	—	10	332	44041
T5	1-1/2"	9.000	3.500	2.625	3 #2 AWG	36.00	—	10	368	44051
T6	2"	11.500	4.125	3.125	3 #1/0 AWG	75.00	—	5	663	44061
T7	2-1/2"	15.000	5.688	4.313	3 #4/0 AWG	138.00	—	1	1271	44071
T8	3"	15.125	5.875	4.313	3 #4/0 AWG	170.00	—	1	1547	44081
T9	3-1/2"	18.125	6.813	4.875	3 #350 MCM	300.00	—	1	2542	44091
T10	4"	18.125	7.188	4.875	3 #350 MCM	328.00	—	1	2542	44101



TYPE TB1

CATALOG NUMBER	TRADE SIZE	DIM A	DIM B	DIM C	MAX WIRE SIZE	VOL. CU.IN.	UNIT PACK	MASTER PACK	LBS. / 100 PCS.	UPC #
TB Type										
TB1	1/2"	5.250	1.313	1.313	N/A	6	10	50	88	64011
TB2	3/4"	6.063	1.563	1.563	3 #6 AWG	9.5	10	50	120	64012
TB3	1"	7.125	1.813	1.813	3 #4 AWG	15	5	25	197	64013
TB4	1-1/4"	9.313	2.438	3.750	3 #2 AWG	33	-	10	343	64014
TB5	1-1/2"	9.313	2.563	3.750	3 #2 AWG	36	-	10	420	64015
TB6	2"	11.813	3.188	4.125	3 #1/0 AWG	75	-	5	691	64016